



## **FIRE SERVICES REPORT 21-03**

---

**TO:** Chairman and Members of Fire Board  
**FROM:** Ralph Snyder – Fire Chief  
**DATE:** November 2, 2021  
**SUBJECT:** RFP #01-21  
**Supply and Delivery of One Walk Around Rescue**

---

### **RECOMMENDATION**

That the Shelburne and District Fire Board receive Fire Services Report # 21-03  
And that the Board provide direction on the purchase of apparatus.

### **PURPOSE/BACKGROUND**

RFP 01-21 to replace the 2004 Rescue 26 was issued on July 5, 2021 and closed on August 13, 2021.

At the September 8, 2021 meeting, the Fire Board approved the purchase from Dependable Emergency Vehicles

### **ANALYSIS AND DISCUSSION**

On October 19, 2021, the Fire Chief and Deputy Chief met with Dependable for a pre-construction meeting. Details were finalized for purchase.

On October 20, 2021, the Fire Chief was informed that, due to global parts shortages, an International Truck chassis would not be available until "late 2023 and perhaps as far as 2024 calendar year". The vendor also contacted Freightliner and Kenworth and was informed of similar timelines.

In review of the current capital forecast and potential truck shortages over the next 3 to 5 years staff evaluated our current purchasing plan and possible acceptable solutions. Revisions are suggested to the capital forecast as follows.

1. Postpone 2004 Rescue 26 replacement until 2024 due to unavailability of chassis
2. Replace 1999 Pumper 27 with an available stock unit immediately
3. Adjust the replacement of 2009 Tanker 25 to a refurbishment in 2025
4. Adjust the replacement of 2012 Ladder 28 to a re-certification annually until 2032

The anticipated cost of a replacement pumper in 2024 is more than \$650,000. The shortage of chassis is also likely to cause a considerable increase in

The Fire Chief and Deputy Chief met with representatives from Dependable again on October 21, 2021. Dependable offered a discounted price on 2 stock Spartan custom pumpers which would meet the requirements for replacing Pumper 27.

### **LEGAL IMPLICATIONS**

A contract will be negotiated by the Fire Chief with Dependable Emergency Vehicles.

### **FINANCIAL IMPLICATIONS**

The allotted \$450,000 for the replacement of Rescue 26 would be re-assigned to the replacement of Pumper 27. An additional \$175,000 would be allocated to this purchase from capital reserves.

Future capital allocation for Rescue 26, Tanker 25 and Ladder 28 would be adjusted under the revised plan providing adequate capital reserves to meet the needs of the department.

### **POLICY IMPLICATIONS**

The Shelburne and District Fire Board of Management would need to approve sole source procurement based on the Purchasing Policy and Procedure, Item 10.2 (f). "When the contractor is already at work on the site (based on an existing Purchase Order) and it would not be practical to engage another contractor."

### **CONSULTATIONS**

Dependable Emergency Vehicles

SDFD truck committee:

DC Clayton, AC Jensen, AC Rideout, FF Glassford, FF Quesnelle

### **ATTACHMENTS**

Appendix A – Letter from Altruck International Truck Centers

Appendix B – Concept drawing for Dependable EV stock pumper 56136

Prepared by:



---

Ralph Snyder  
Fire Chief



October 15, 2021

To our valued customers:

For the last 18 months we have been exposed to more uncertainty and instability than what has been experienced by most in recent memory. The resilience of our Country, businesses, staff and communities is nothing short of remarkable. Looking ahead to the next twelve months, we are faced with differing uncertainties but remain optimistic that the next year will deliver a healthier and more certain future for everyone. As we collectively participate in vaccine deployments and charge ahead to the fall of '21 optimism is everywhere.

The anticipation of the "re-opening" of the North American economy has resulted in a historical spike in demand for product of which has been coupled by global industry material shortages that present challenges for Original Equipment Manufacturers, related supply chain and International Truck®.

Currently, International Truck® has an unprecedented demand for product that has not been seen since the economic boom of the 1990's. Coupled with global material/supply strains, our current production is experiencing major delays. As International Truck® and our industry at-large experiences these challenges, dealers and customers have been unable to order vehicles for over 90 days resulting in unprecedented pent-up demand. At present, we anticipate that we will be unable to order vehicles for our clients for an additional 90 days from today, further amplifying the pent-up demand across our industry. Our prediction is that when our ability to order vehicles re-opens, the 180+ days of pent-up demand across North America will push production in to late 2023 and perhaps as far as 2024 calendar year.

Given this information, Altruck is leveraging every available tool to assist our clients in securing orders as needed when our ability to order trucks re-opens. In order to do so, we expect that we will have less than one week to order customer's vehicles before we lose another 6 – 12 months of production capacity.

As a result, we are enlisting our team of Account Managers to actively work with you, our customer(s), to ensure all of your needs are properly identified prior to the order board re-opening in the months to come so as to ensure you receive priority build slots if needed. Our goal is to help you secure the tools you need for the future of your business before time runs out.

Your Account Manager will provide all of the necessary information needed to participate in our Priority Customer Production Program should this be of interest to you. If you do not have an Account Manager, please contact us at 1(888)650-1111 or online at [www.ALTRUCK.com](http://www.ALTRUCK.com) so we can assist further. It is our commitment to ensure our local business partners and customers remain a priority. This is our way of helping you hedge against unprecedented supply chain constraints as well as surging demand.

To our customers who have vehicles on order and are currently experiencing delays, we want to thank you for your continued patience and patronage during what are frustrating circumstances. It is our commitment to ensure delays in manufacturing that impact your current and future orders are communicated as quickly as possible so as to ensure you have the most up-to-date information.

We are excited to charge through this part of our history and we look forward to a healthy and prosperous future together.

Warm regards,

Matthew E. Kirby and the Altruck team.

Altruck International Truck Centres  
Div of Kirby International Trucks Ltd



IT'S UPTIME

Goderich – Kitchener – Cambridge – Guelph – Hamilton – Burlington

[www.ALTRUCK.com](http://www.ALTRUCK.com)

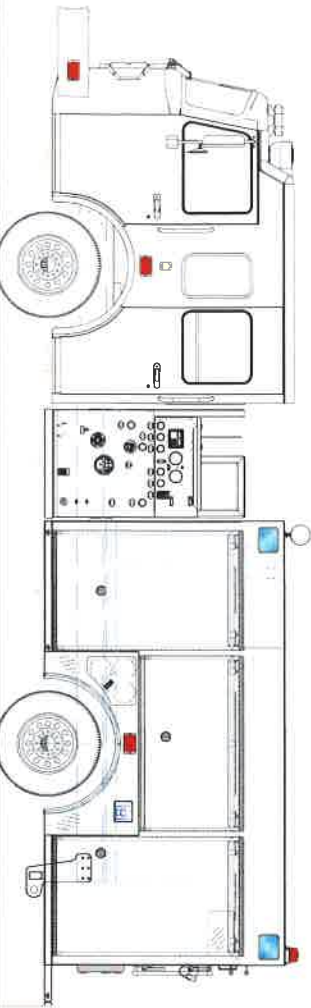
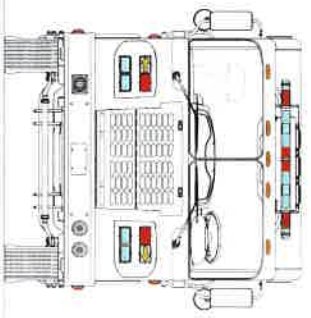
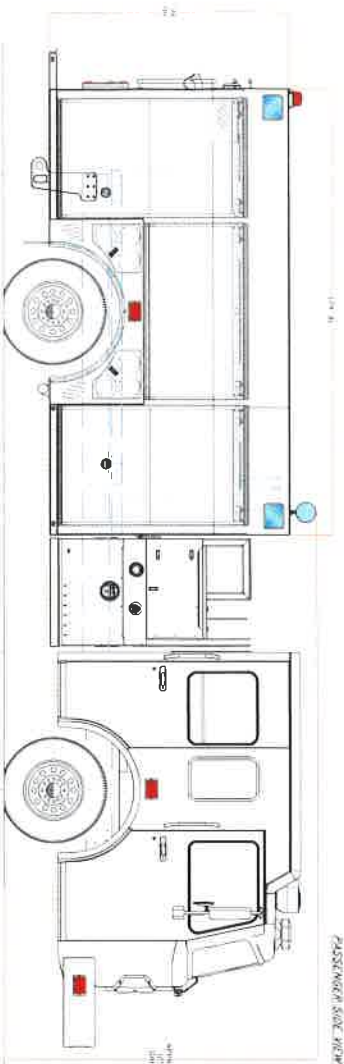
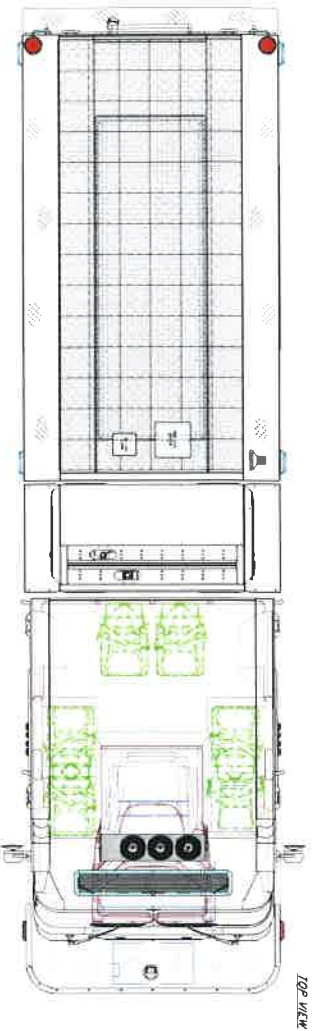

DEPENDABLE EMERGENCY VEHICLES

THIS DRAWING IS A CLOSE APPROXIMATION OF YOUR FUTURE VEHICLE. IN ALL CASES, WHEN THE DRAWING AND THE WRITTEN SPECIFICATION CONTRADICT, THE WRITTEN SPECIFICATION SHALL PREVAIL. THIS DRAWING IS NOT TO BE USED FOR ANY OTHER PURPOSES WITHOUT THE WRITTEN PERMISSION OF THE DRAWING PRODUCER.

APPROVED BY CUSTOMER

DATE

### SALES CONCEPTUAL DRAWING ONLY

ALL DIMENSIONS ARE IN INCHES

ALL DIMENSIONS ARE SUBJECT TO CHANGE AND TO APPROVAL OF THE CUSTOMER

UNLESS OTHERWISE NOTED, TOLERANCES ARE:



SPOT WELDING

THIS DRAWING IS THE CONCEPTUAL PROPERTY OF DEPENDABLE EMERGENCY VEHICLES

DRAWN BY: PC

CUSTOMER: SICKLE PUMPER 36156

DESCRIPTION

PUMPER

SPC #

36156

DWG #

36156

DATE

09/01/21

DWG #

36156

#### CAB

CAB & CHASSIS WEIGHT: 2000 LBS. (MAXIMUM WEIGHT: 2000 LBS.)

ENGINE: 100 HP (MAXIMUM) 100 HP (MAXIMUM)

TRANSMISSION: 1700 LBS. (MAXIMUM) 1700 LBS. (MAXIMUM)

STEERING: 1000 LBS. (MAXIMUM) 1000 LBS. (MAXIMUM)

WHEELS: 1000 LBS. (MAXIMUM) 1000 LBS. (MAXIMUM)

WHEELS: 1000 LBS. (MAXIMUM) 1000 LBS. (MAXIMUM)

WHEELS: 1000 LBS. (MAXIMUM) 1000 LBS. (MAXIMUM)

WHEELS: 1000 LBS. (MAXIMUM) 1000 LBS. (MAXIMUM)

WHEELS: 1000 LBS. (MAXIMUM) 1000 LBS. (MAXIMUM)

WHEELS: 1000 LBS. (MAXIMUM) 1000 LBS. (MAXIMUM)

WHEELS: 1000 LBS. (MAXIMUM) 1000 LBS. (MAXIMUM)

WHEELS: 1000 LBS. (MAXIMUM) 1000 LBS. (MAXIMUM)

WHEELS: 1000 LBS. (MAXIMUM) 1000 LBS. (MAXIMUM)

WHEELS: 1000 LBS. (MAXIMUM) 1000 LBS. (MAXIMUM)

WHEELS: 1000 LBS. (MAXIMUM) 1000 LBS. (MAXIMUM)

WHEELS: 1000 LBS. (MAXIMUM) 1000 LBS. (MAXIMUM)

WHEELS: 1000 LBS. (MAXIMUM) 1000 LBS. (MAXIMUM)

WHEELS: 1000 LBS. (MAXIMUM) 1000 LBS. (MAXIMUM)

WHEELS: 1000 LBS. (MAXIMUM) 1000 LBS. (MAXIMUM)

WHEELS: 1000 LBS. (MAXIMUM) 1000 LBS. (MAXIMUM)

WHEELS: 1000 LBS. (MAXIMUM) 1000 LBS. (MAXIMUM)

WHEELS: 1000 LBS. (MAXIMUM) 1000 LBS. (MAXIMUM)

WHEELS: 1000 LBS. (MAXIMUM) 1000 LBS. (MAXIMUM)

WHEELS: 1000 LBS. (MAXIMUM) 1000 LBS. (MAXIMUM)

WHEELS: 1000 LBS. (MAXIMUM) 1000 LBS. (MAXIMUM)

WHEELS: 1000 LBS. (MAXIMUM) 1000 LBS. (MAXIMUM)

WHEELS: 1000 LBS. (MAXIMUM) 1000 LBS. (MAXIMUM)

WHEELS: 1000 LBS. (MAXIMUM) 1000 LBS. (MAXIMUM)

WHEELS: 1000 LBS. (MAXIMUM) 1000 LBS. (MAXIMUM)

WHEELS: 1000 LBS. (MAXIMUM) 1000 LBS. (MAXIMUM)

WHEELS: 1000 LBS. (MAXIMUM) 1000 LBS. (MAXIMUM)

WHEELS: 1000 LBS. (MAXIMUM) 1000 LBS. (MAXIMUM)

WHEELS: 1000 LBS. (MAXIMUM) 1000 LBS. (MAXIMUM)

WHEELS: 1000 LBS. (MAXIMUM) 1000 LBS. (MAXIMUM)

WHEELS: 1000 LBS. (MAXIMUM) 1000 LBS. (MAXIMUM)

WHEELS: 1000 LBS. (MAXIMUM) 1000 LBS. (MAXIMUM)

WHEELS: 1000 LBS. (MAXIMUM) 1000 LBS. (MAXIMUM)

WHEELS: 1000 LBS. (MAXIMUM) 1000 LBS. (MAXIMUM)

WHEELS: 1000 LBS. (MAXIMUM) 1000 LBS. (MAXIMUM)

WHEELS: 1000 LBS. (MAXIMUM) 1000 LBS. (MAXIMUM)

WHEELS: 1000 LBS. (MAXIMUM) 1000 LBS. (MAXIMUM)

WHEELS: 1000 LBS. (MAXIMUM) 1000 LBS. (MAXIMUM)

WHEELS: 1000 LBS. (MAXIMUM) 1000 LBS. (MAXIMUM)

WHEELS: 1000 LBS. (MAXIMUM) 1000 LBS. (MAXIMUM)

WHEELS: 1000 LBS. (MAXIMUM) 1000 LBS. (MAXIMUM)

WHEELS: 1000 LBS. (MAXIMUM) 1000 LBS. (MAXIMUM)

WHEELS: 1000 LBS. (MAXIMUM) 1000 LBS. (MAXIMUM)

WHEELS: 1000 LBS. (MAXIMUM) 1000 LBS. (MAXIMUM)

WHEELS: 1000 LBS. (MAXIMUM) 1000 LBS. (MAXIMUM)

WHEELS: 1000 LBS. (MAXIMUM) 1000 LBS. (MAXIMUM)

WHEELS: 1000 LBS. (MAXIMUM) 1000 LBS. (MAXIMUM)

WHEELS: 1000 LBS. (MAXIMUM) 1000 LBS. (MAXIMUM)

WHEELS: 1000 LBS. (MAXIMUM) 1000 LBS. (MAXIMUM)

WHEELS: 1000 LBS. (MAXIMUM) 1000 LBS. (MAXIMUM)

WHEELS: 1000 LBS. (MAXIMUM) 1000 LBS. (MAXIMUM)

WHEELS: 1000 LBS. (MAXIMUM) 1000 LBS. (MAXIMUM)

WHEELS: 1000 LBS. (MAXIMUM) 1000 LBS. (MAXIMUM)

WHEELS: 1000 LBS. (MAXIMUM) 1000 LBS. (MAXIMUM)

WHEELS: 1000 LBS. (MAXIMUM) 1000 LBS. (MAXIMUM)

WHEELS: 1000 LBS. (MAXIMUM) 1000 LBS. (MAXIMUM)

WHEELS: 1000 LBS. (MAXIMUM) 1000 LBS. (MAXIMUM)

WHEELS: 1000 LBS. (MAXIMUM) 1000 LBS. (MAXIMUM)

WHEELS: 1000 LBS. (MAXIMUM) 1000 LBS. (MAXIMUM)

WHEELS: 1000 LBS. (MAXIMUM) 1000 LBS. (MAXIMUM)

WHEELS: 1000 LBS. (MAXIMUM) 1000 LBS. (MAXIMUM)

WHEELS: 1000 LBS. (MAXIMUM) 1000 LBS. (MAXIMUM)

WHEELS: 1000 LBS. (MAXIMUM) 1000 LBS. (MAXIMUM)

WHEELS: 1000 LBS. (MAXIMUM) 1000 LBS. (MAXIMUM)

WHEELS: 1000 LBS. (MAXIMUM) 1000 LBS. (MAXIMUM)

WHEELS: 1000 LBS. (MAXIMUM) 1000 LBS. (MAXIMUM)

WHEELS: 1000 LBS. (MAXIMUM) 1000 LBS. (MAXIMUM)

WHEELS: 1000 LBS. (MAXIMUM) 1000 LBS. (MAXIMUM)

WHEELS: 1000 LBS. (MAXIMUM) 1000 LBS. (MAXIMUM)

WHEELS: 1000 LBS. (MAXIMUM) 1000 LBS. (MAXIMUM)

WHEELS: 1000 LBS. (MAXIMUM) 1000 LBS. (MAXIMUM)

WHEELS: 1000 LBS. (MAXIMUM) 1000 LBS. (MAXIMUM)

WHEELS: 1000 LBS. (MAXIMUM) 1000 LBS. (MAXIMUM)

WHEELS: 1000 LBS. (MAXIMUM) 1000 LBS. (MAXIMUM)

WHEELS: 1000 LBS. (MAXIMUM) 1000 LBS. (MAXIMUM)

WHEELS: 1000 LBS. (MAXIMUM) 1000 LBS. (MAXIMUM)

WHEELS: 1000 LBS. (MAXIMUM) 1000 LBS. (MAXIMUM)

WHEELS: 1000 LBS. (MAXIMUM) 1000 LBS. (MAXIMUM)

WHEELS: 1000 LBS. (MAXIMUM) 1000 LBS. (MAXIMUM)

WHEELS: 1000 LBS. (MAXIMUM) 1000 LBS. (MAXIMUM)

WHEELS: 1000 LBS. (MAXIMUM) 1000 LBS. (MAXIMUM)

WHEELS: 1000 LBS. (MAXIMUM) 1000 LBS. (MAXIMUM)

WHEELS: 1000 LBS. (MAXIMUM) 1000 LBS. (MAXIMUM)

WHEELS: 1000 LBS. (MAXIMUM) 1000 LBS. (MAXIMUM)